

MiBOXER[®]

Mi • Light Subordinate New Brand

9W RGB+CCT LED Downlight

Model No.: FUT061

Features



RGB+CCT
16 Millions of colors to choose



Color temperature
2700~6500K



Dimmable
saturation control



2.4G RF wireless transmission
technology



Remote control
control distance 30m



Smart phone App control
(WiFi Box or 2.4GHz gateway is needed)



Support third party voice control
(2.4GHz gateway is needed)

Parameters

Model No.: FUT061

Input: AC100~240V 50/60Hz

Power: 9W

Working Temp.: -20~60°C

Color Temp.: 2700K~6500K

Luminous Flux: 720LM

Light Efficiency: 80LM/W

CRI: >80

PF: >0.5

Lifespan: 50000 hours

Beam Angle: 120°

RF: 2.4GHz

Control Distance: 30m

Hole Size: \varnothing 110~125mm

Material: Aluminum

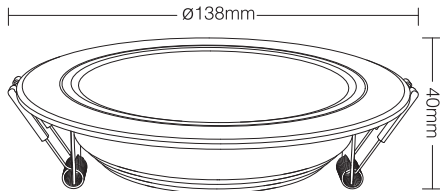

Hole Size: \varnothing 110~125mm

Instructions

1. Please open the hole on the ceiling according to the correct size of Diagram 1.
2. Connect the driver properly according to the wire connection Diagram 2. And then put the driver and wire into the ceiling from the hole.
3. Push in the two spring elements, make sure that they are deployed and anchored on the back of the ceiling Diagram 3 and 4.

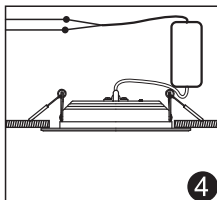
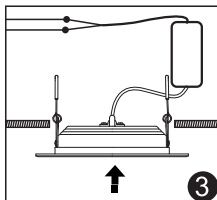
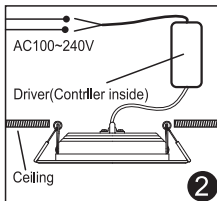
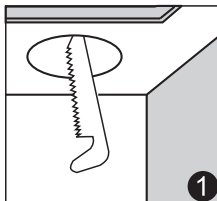

Link / Unlink

Compatible with these remote controls
(Purchased separately)



FUT089



FUT092



FUT088



FUT095



FUT096



B8

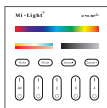

B4 / T4

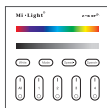

B3 / T3



B0

 **NOTE:**

Lighting can be working after linking with remote;
for more details, pls read the remote instruction.

Dynamic Mode Sheet

Number	Dynamic Mode	Saturation	Brightness & Speed
1	Colors gradual change	Adjustable	Adjustable
2	White light Gradual change	Unadjustable	
3	RGB gradual change	Adjustable	
4	Seven colors jump to change		
5	Jump to change randomly		
6	Red light gradual change +Flash 3 times		
7	Green light gradual change +Flash 3 times		
8	Blue light gradual change +Flash 3 times		
9	White light gradual change +Flash 3 times	Unadjustable	

Attention

1. When install the lighting fixtures, pls switch off the power to make sure the safty.
2. Please check whether the input voltage supply is in accordance with the lighting fixtures.
3. Non-professional user cannot dismantle the lighting fixtures directly, otherwise, it may cause fire and electric shock.
4. Please do not use lighting fixtures around the mental area and high magnetic field, otherwise, it will badly affect the control distance.



www.futlight.com

Made in China

