

Introduction

Controller adopt the widely used 2.4G wireless technology with the features of low power consumption, long signal transmitting and strong anti-interference, etc. Controller has auto-transmitting and auto-synchronizing function. Widely used on the controlling of hotel lighting and home lighting.

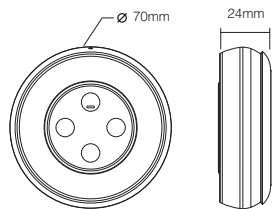
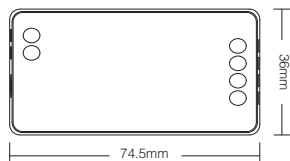

RGB LED Controller Kit

Model No.: FUT037SA

RGB LED Controller Kits







Model No.: FUT037SA

LED Controller

Working Voltage: DC12V~24V
Output: 6A/Channel
Total Output: Max 12A
RF: 2.4GHz
Control Distance: 30m
Working Temperature: -10~40°C
Output Connection: Common anode

Rainbow Remote

Working Voltage: 3V(AAA*2PCS)
Transmitting Power: 6dBm
Standby Power: 20uA
RF: 2.4GHz
Modulation Method: GFSK

-  16 Millions of colors to choose
-  Remote control
Control distance 30m
-  Mix Red, Green and Blue light to adjust color temperature
-  Smartphone App control
(2.4GHz gateway is needed)
-  Dim brightness / saturation
-  Support third party voice control
(2.4GHz gateway is needed)
-  2.4G RF wireless transmission technology

Button Diagram



Touch ring: brightness, saturation, color temperature, RGB use together.
(It turns to adjust brightness by default if remote is not operated for 3 seconds)

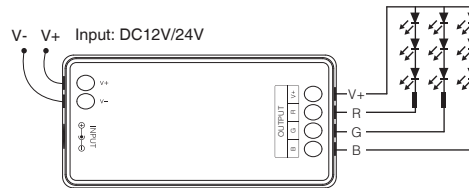

Install The Battery For Remote



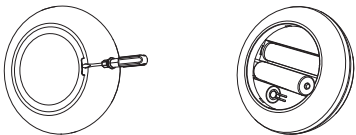







Note: 2*AAA Battery need to buy seperately



1. Open battery cover behind remote.

2. Install battery correctly and close battery cover.

Remote Instruction

- Adjust RGB
Short press  key twice in succession, and then touch  to adjust RGB.
- Adjust color temperature
Short press  key once, then touch  to adjust color temp.
- Adjust saturation
Press  key twice in succession, and then touch  to adjust color saturation of lighting.
- Adjust brightness
Short press  key once, then touch  to adjust brightness.
- Dynamic mode switching
Long press  key until indicator light flashes twice, then short press  key to cycle switch.
(Note: it will exit automatically if no operation after 3 seconds)

Linking Code / Unlinking Code Instructions

Attention: No need to match code since its already matched code in factory setting

Linking Code Instructions

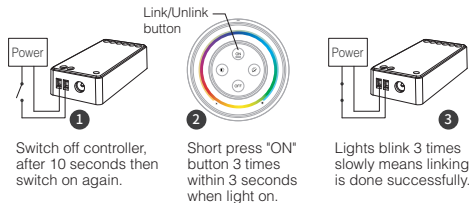

Switch off controller, after 10 seconds then switch on again.

Short press "ON" button 3 times within 3 seconds when light on.

Lights blink 3 times slowly means linking is done successfully.

 Linking failed if light is not blinking slowly, Please follow above steps again.(Note: controller that have linked can't link again)

Unlinking Code Instructions

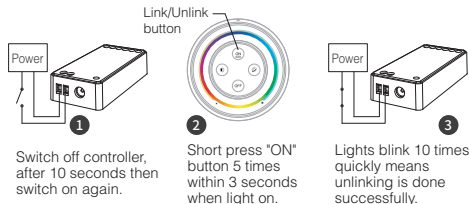

Switch off controller, after 10 seconds then switch on again.

Short press "ON" button 5 times within 3 seconds when light on.

Lights blink 10 times quickly means unlinking is done successfully.

 Unlinking failed if light is not blinking quickly, Please follow above steps again.(Note: controller haven't linked that don't need to unlink)

Signal transmitting

One controller can transmit the signals from the remote control to another controller within 30m, as long as there is a controller within 30m, the remote control distance can be limitless.

Modes synchronization

Different controllers can work synchronously when they are started at different times, controlled by the same remote, under same dynamic mode and within 30m distance.

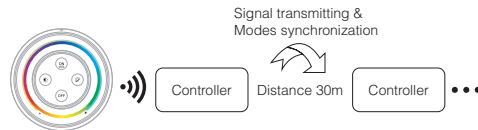

PWM high frequency / low frequency switching

Switch to high frequency (8KHz): on the condition of turning on the light

1. Short press the "OFF" button of the remote control once;
2. Short press the "ON" button 5 times within 3 seconds, the white light blink 2 times quickly, indicating successfully.

Switch to low frequency (500Hz): on the condition of turning off the light

1. Short press the "ON" button of the remote control once;
2. Short press the "OFF" button 5 times within 3 seconds, the white light blink 2 times slowly, indicating successfully.

Dynamic mode table

Number	Dynamic Mode	Brightness / Saturation
1	Mardi Gras	Adjustable
2	Automatic color change	
3	Sam	
4	Gemstone	
5	Twilight	
6	American	
7	Fat Tuesday	
8	Party	
9	Slow Color Splash	

Attention

1. Please check whether the voltage of the power supply is in accordance with the controller, and please check the connection of both the cathode and anode, otherwise the controller will be broken.
2. Please don't connect wires with power on. Please turn on again only when it is in right connection and no short circuit.
3. Please do not use the controller in the place with widely range metal area or strong electromagnetic wave nearby, otherwise, the remote distance will be seriously affected .

      Controller can not use in humid area
Made in China