

Connection Diagram

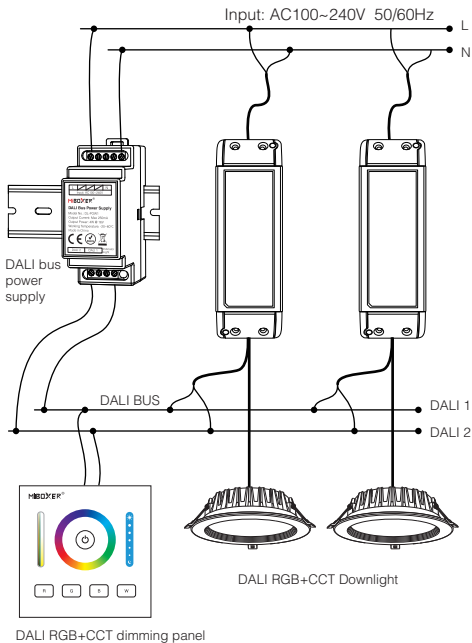

MIBOXER[®]

Mi·Light
Subordinate New Brand

DALI Bus Power Supply (DIN Rail)

Model No.: DLPOW1

Features

DLPOW1 is a newly developed DALI BUS Power Supply, up to Class 2 power supply standard and SELV safety extra-low voltage standard; It's with short-circuit protection and low-voltage protection; The case is with anti-fire material.

Parameters

Model No.: DLPOW1

Input Voltage: AC100~240V 50/60Hz

Input Current: 115Vac/≤0.09A, 230Vac/≤0.05A

Leakage Current: <0.5mA/230Vac

Inrush Current: Cold start 10A at 230Vac

Setup Time: 115Vac<2500ms, 230Vac<1500ms (at full load)

Output Voltage: DC16V

Output Current: 250mA Max

Max. Rated Power: 4W

Ripple & Noise: 0.2Vp-p (at full load)

Working Temp.: -20 ~ 60°C

Working Humidity: 20 ~ 95%RH, non-condensing

Weight: 70g

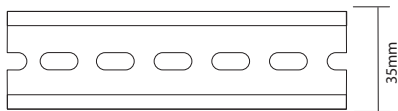
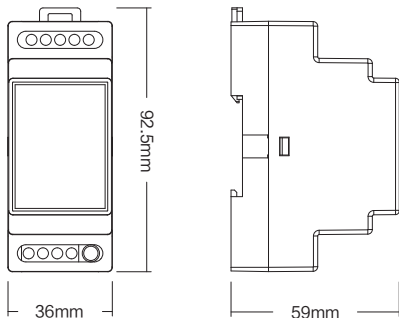

DIN-Rail mounting size: TS-35/7.5 or TS-35/15
(Purchasing separately)

Safety & EMC

Isolation Resistance: I/P-O/P: 100MΩ/500VDC/25°C/70%RH



Made in China